

A47 Wansford to Sutton Dualling

Scheme Number: TR010039

Volume 2 **2.4 Rights of Way and Access Plans**

APFP Regulation 5(2)(k) and 5(2)(o)

Planning Act 2008

Infrastructure Planning (Applications: Prescribed
Forms and Procedure) Regulations 2009

June 2022

Deadline 8

Infrastructure Planning

Planning Act 2008

**The Infrastructure Planning
(Applications: Prescribed Forms and
Procedure) Regulations 2009**

A47 Wansford to Sutton
Development Consent Order 202[x]

2.4 RIGHTS OF WAY AND ACCESS PLANS

Regulation Number	Regulation 5(2)(k) and 5(2)(o)
Planning Inspectorate Scheme Reference	TR010039
Application Document Reference	TR010039/APP/2.4
BIM Document Reference	HE551494-GTY-LSI-000-RP-TX-30014
Author	A47 Wansford to Sutton Dualling Project Team, National Highways

Version	Date	Status of Version
Rev 0	June 2021	Application Issue
Rev 1	August 2021	Updated following PINS advice
Rev 2	February 2022	Deadline 2
Rev 3	June 2022	Deadline 8

CONTENTS

1	INTRODUCTION.....	1
1.1	Purpose of this Document.....	1
2	SCHEDULE OF PLANS INCLUDED IN THIS APPLICATION DOCUMENT	2

1 INTRODUCTION

1.1 Purpose of this Document

- 1.1.1 These Rights of Way and Access Plans (these “Plans”) relate to an application made by Highways England (the “Applicant”) to the Secretary of State for Transport, via the Planning Inspectorate (the “Inspectorate”) under the Planning Act 2008 (the “2008 Act”) for a Development Consent Order (DCO). If made, the DCO would grant consent for the Wansford to Sutton Scheme (the “Scheme”).
- 1.1.2 The Scheme comprises the alteration of an existing highway by way of an upgrade to an existing 2.6km of single carriageway between Wansford to Sutton. It will create a new dual carriageway, to improve traffic flow and reduce congestion on the route. A detailed description of the Scheme can be found in Chapter 2: The Proposed Scheme of the Environmental Statement (ES) (**TR010039/APP/6.1**). These Plans cover the Scheme in its entirety.
- 1.1.3 These Plans comprise part of a suite of application documentation and are included in the application in compliance with Regulations 5(2)(k) and 5(2)(o) of the Infrastructure Planning (Prescribed Forms and Procedure) Regulations 2009 which requires:
- 5(2)(k) “where applicable, a plan identifying any new or altered means of access, stopping up of streets or roads or any diversions, extinguishments or creation of rights of way or public rights of navigation”*
- 5(2)(o) “any other plans, drawings and sections necessary to describe the proposals for which development consent is sought, showing details of design, external appearance, and the preferred layout of buildings and structures, drainage, surface water management, means of vehicular and pedestrian access, any car parking to be provided and means of landscaping”.*
- 1.1.4 These Plans also contain a key plan in order to comply with Regulation 5(4) of the 2009 Regulations which states:
- “Where a plan comprises three or more separate sheets a key plan must be provided showing the relationship between the different sheets.”*
- 1.1.5 As these Plans are part of the application documentation, they should be read alongside and informed by the other application documents. In particular, the Plans should be read alongside Schedule 3 and 4 of the draft DCO (**TR010039/APP/3.1**) (the plans show Part 6 of Schedule 3 and Parts 1-5 of Schedule 4).

2 SCHEDULE OF PLANS INCLUDED IN THIS APPLICATION DOCUMENT

Drawing Title	DCO Document Number	Drawing Number	Revision
Rights of Way and Access Plans - Regulation 5(2)(k) and 5(2)(o) Sheet 1 of 7	TR010039/APP/2.4 /1of7 Rev 2	HE551494-GTY-HKF-000-DR-CH-31001	P04
Rights of Way and Access Plans - Regulation 5(2)(k) and 5(2)(o) Sheet 2 of 7	TR010039/APP/2.4 /2of7 Rev 2	HE551494-GTY-HKF-000-DR-CH-31002	P04
Rights of Way and Access Plans - Regulation 5(2)(k) and 5(2)(o) Sheet 3 of 7	TR010039/APP/2.4 /3of7 Rev 2	HE551494-GTY-HKF-000-DR-CH-31003	P04
Rights of Way and Access Plans - Regulation 5(2)(k) and 5(2)(o) Sheet 4 of 7	TR010039/APP/2.4 /4of7 Rev 2	HE551494-GTY-HKF-000-DR-CH-31004	P04
Rights of Way and Access Plans - Regulation 5(2)(k) and 5(2)(o) Sheet 5 of 7	TR010039/APP/2.4 /5of7 Rev 2	HE551494-GTY-HKF-000-DR-CH-31005	P04
Rights of Way and Access Plans - Regulation 5(2)(k) and 5(2)(o) Sheet 6 of 7	TR010039/APP/2.4 /6of7 Rev 2	HE551494-GTY-HKF-000-DR-CH-31006	P04
Rights of Way and Access Plans - Regulation 5(2)(k) and 5(2)(o) Sheet 7 of 7	TR010039/APP/2.4 /7of7 Rev 2	HE551494-GTY-HKF-000-DR-CH-31007	P04
Rights of Way and Access Plans - Regulation 5(2)(k) and 5(2)(o) Key Plan	TR010039/APP/2.4 /7of7 Rev 2	HE551494-GTY-HGN-000-DR-CH-35008	C02

This drawing should not be relied on or used in circumstances other than those for which it was originally prepared and for which Sweco UK Ltd was commissioned. Sweco UK Ltd accepts no responsibility for this drawing to any party other than the person by whom it was commissioned. This drawing has been prepared on behalf of Galliford Try by Sweco UK Ltd for the titled project and should not be relied upon or used for any other project without an independent check being carried out as to its suitability and prior written authority of Galliford Try being obtained. Sweco UK Ltd accepts no responsibility or liability for the consequences of this drawing being used for a purpose other than the purposes for which it was commissioned. Any person using or relying on this drawing for such other purpose agrees, and will by such use or reliance be taken to confirm his/her agreement, to indemnify Sweco UK Ltd for all loss or damage resulting therefrom.

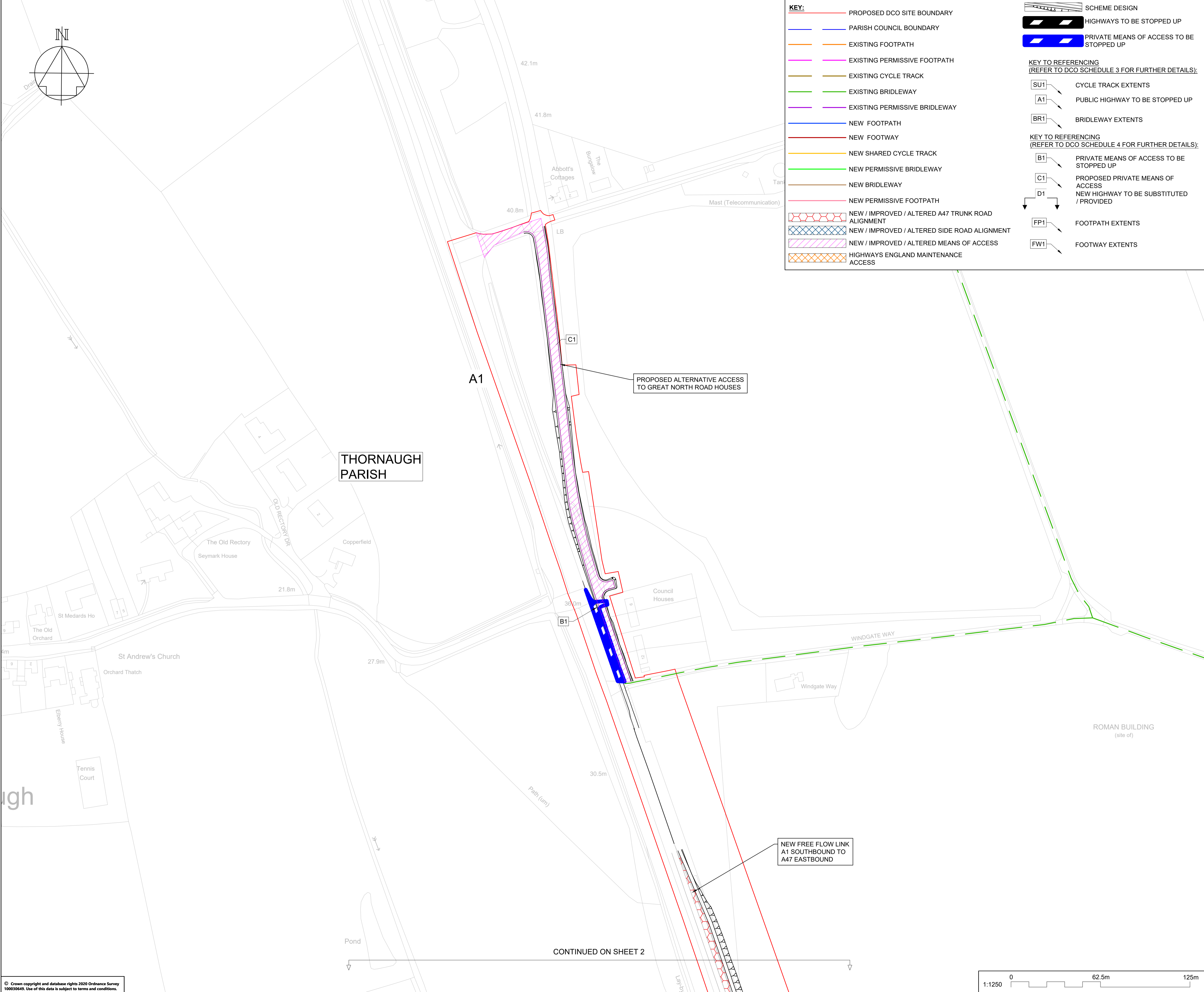

KEY:

- PROPOSED DCO SITE BOUNDARY
- PARISH COUNCIL BOUNDARY
- EXISTING FOOTPATH
- EXISTING PERMISSIVE FOOTPATH
- EXISTING CYCLE TRACK
- EXISTING BRIDLEWAY
- EXISTING PERMISSIVE BRIDLEWAY
- NEW FOOTPATH
- NEW FOOTWAY
- NEW SHARED CYCLE TRACK
- NEW PERMISSIVE BRIDLEWAY
- NEW BRIDLEWAY
- NEW PERMISSIVE FOOTPATH
- NEW / IMPROVED / ALTERED A47 TRUNK ROAD ALIGNMENT
- NEW / IMPROVED / ALTERED SIDE ROAD ALIGNMENT
- NEW / IMPROVED / ALTERED MEANS OF ACCESS
- HIGHWAYS ENGLAND MAINTENANCE ACCESS

KEY TO REFERENCING (REFER TO DCO SCHEDULE 3 FOR FURTHER DETAILS):

- SU1 — CYCLE TRACK EXTENTS
- A1 — PUBLIC HIGHWAY TO BE STOPPED UP
- BR1 — BRIDLEWAY EXTENTS

KEY TO REFERENCING (REFER TO DCO SCHEDULE 4 FOR FURTHER DETAILS):

- B1 — PRIVATE MEANS OF ACCESS TO BE STOPPED UP
- C1 — PROPOSED PRIVATE MEANS OF ACCESS
- D1 — NEW HIGHWAY TO BE SUBSTITUTED / PROVIDED
- FP1 — FOOTPATH EXTENTS
- FW1 — FOOTWAY EXTENTS

SCHEME DESIGN

- HIGHWAYS TO BE STOPPED UP
- PRIVATE MEANS OF ACCESS TO BE STOPPED UP

NOTES

Purpose of use
FOR DCO SUBMISSION

Development Consent Order Number / Document
TR010039/APP/2.4

SHEET PLAN

SHEETS 1 - 7 (INCLUDES INSETS 3A, 5B AND 7C)

1. THESE PLANS SHOULD BE READ IN CONJUNCTION WITH OTHER PLANS AND DOCUMENTS IN THE DEVELOPMENT CONSENT ORDER.
2. ALL DIMENSIONS ARE IN METRES UNLESS STATED OTHERWISE.

REV	DATE	REVISION NOTE	ORG	CHKD	APPD
P01	16/06/21	SGAR3 ISSUE	CDye	AWoo	SCM
C01	16/06/21	SGAR3 ISSUE	CDye	AWoo	SCM
P02	01/07/21	DCO ISSUE	CDye	AWoo	SCM
C02	01/07/21	DCO ISSUE	CDye	AWoo	SCM
P03	15/02/22	UPDATED KEY WITH NEW BRIDLEWAY 'BR'	RO	PE	MMur
P04	10/06/22	DEADLINE SUBMISSION 8	FWig	MMcD	SCM

DESIGNER
SWECO

CONTRACTOR
GallifordTry

CLIENT
highways england

PROJECT TITLE
A47 WANSFORD TO SUTTON DUALLING

PROJECT STAGE
PCF STAGE 4

DRAWING TITLE
**RIGHTS OF WAY AND ACCESS PLANS
REGULATION 5(2)(k) and 5(2)(o)
SHEET 1 OF 7**

SUITABILITY
SUITABLE FOR INFORMATION

SHEET SIZE	SCALE	STATUS	REVISION
A1	1:1250	S2	P04

DRAWING NUMBER
HE551494-GTY-HKF-000-DR-CH-31001

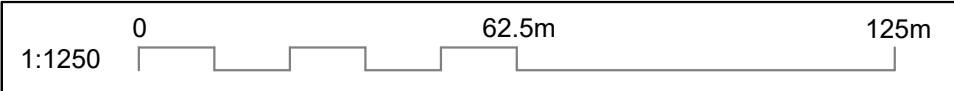

CONTINUED ON SHEET 2

This drawing should not be relied on or used in circumstances other than those for which it was originally prepared and for which Sweco UK Ltd was commissioned. Sweco UK Ltd accepts no responsibility for this drawing to any party other than the person by whom it was commissioned. This drawing has been prepared on behalf of Galliford Try by Sweco UK Ltd for the titled project or named part thereof and should not be relied upon or used for any other project without an independent check being carried out as to its suitability and prior written authority of Galliford Try being obtained. Sweco UK Ltd accepts no responsibility or liability for the consequences of this drawing being used for a purpose other than the purposes for which it was commissioned. Any person using or relying on this drawing for such other purpose agrees, and will by such use or reliance be taken to confirm his/her agreement, to indemnify Sweco UK Ltd for all loss or damage resulting therefrom.

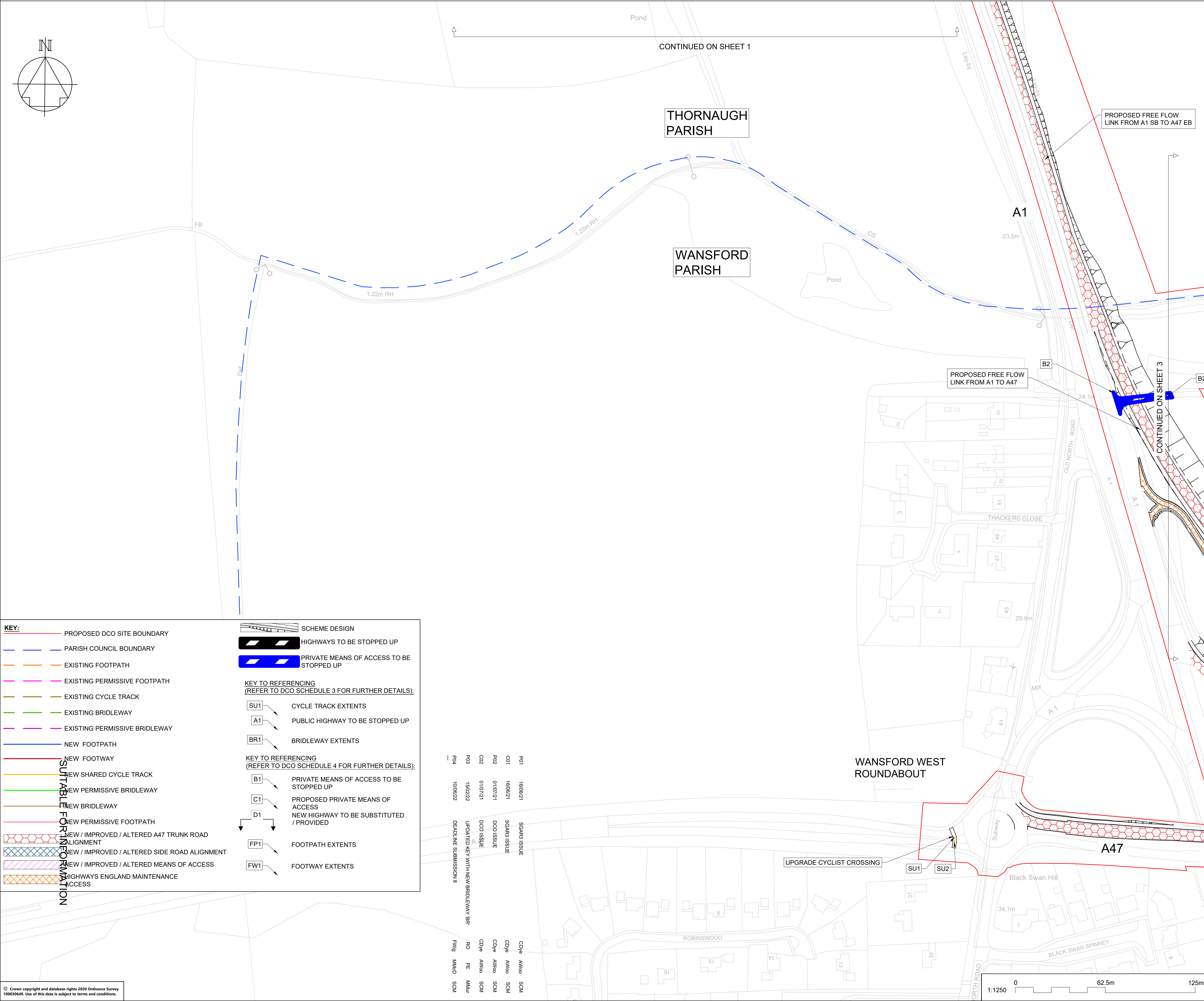
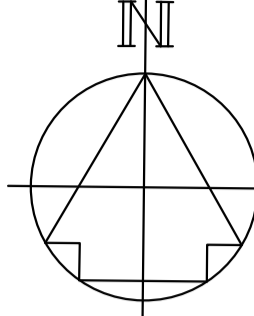

KEY:

- PROPOSED DCO SITE BOUNDARY
- PARISH COUNCIL BOUNDARY
- EXISTING FOOTPATH
- EXISTING PERMISSIVE FOOTPATH
- EXISTING CYCLE TRACK
- EXISTING BRIDLEWAY
- EXISTING PERMISSIVE BRIDLEWAY
- NEW FOOTPATH
- NEW FOOTWAY
- NEW SHARED CYCLE TRACK
- NEW PERMISSIVE BRIDLEWAY
- NEW BRIDLEWAY
- NEW PERMISSIVE FOOTPATH
- NEW / IMPROVED / ALTERED A47 TRUNK ROAD ALIGNMENT
- NEW / IMPROVED / ALTERED SIDE ROAD ALIGNMENT
- NEW / IMPROVED / ALTERED MEANS OF ACCESS
- HIGHWAYS ENGLAND MAINTENANCE ACCESS

SCHEME DESIGN

- HIGHWAYS TO BE STOPPED UP
- PRIVATE MEANS OF ACCESS TO BE STOPPED UP

KEY TO REFERENCING (REFER TO DCO SCHEDULE 3 FOR FURTHER DETAILS):

- SU1 CYCLE TRACK EXTENTS
- A1 PUBLIC HIGHWAY TO BE STOPPED UP
- BR1 BRIDLEWAY EXTENTS

KEY TO REFERENCING (REFER TO DCO SCHEDULE 4 FOR FURTHER DETAILS):

- B1 PRIVATE MEANS OF ACCESS TO BE STOPPED UP
- C1 PROPOSED PRIVATE MEANS OF ACCESS
- D1 NEW HIGHWAY TO BE SUBSTITUTED / PROVIDED
- FP1 FOOTPATH EXTENTS
- FW1 FOOTWAY EXTENTS

SUITABLE FOR INFORMATION

P01	16/06/21	SGAR3 ISSUE	CDye	AWoo	SCM
C01	16/06/21	SGAR3 ISSUE	CDye	AWoo	SCM
P02	01/07/21	DCO ISSUE	CDye	AWoo	SCM
C02	01/07/21	DCO ISSUE	CDye	AWoo	SCM
P03	15/02/22	UPDATED KEY WITH NEW BRIDLEWAY 'BR'	RO	PE	MMur
P04	10/06/22	DEADLINE SUBMISSION 8	FWg	MMcD	SCM
		UPDATE KEY WITH NEW BRIDLEWAY 'BR'	RO	PE	MMur
		DEADLINE SUBMISSION 8	FWg	MMcD	SCM

NOTES

Purpose of use
FOR DCO SUBMISSION

Development Consent Order Number / Document
TR010039/APP/2.4

SHEET PLAN

SHEETS 1 - 7 (INCLUDES INSETS 3A, 5B AND 7C)

WANSFORD RAILWAY UNDERPASS

A47/A1 JUNCTION

SACREWELL FARM UNDERBRIDGE

NEW ROUNDABOUT

1. THESE PLANS SHOULD BE READ IN CONJUNCTION WITH OTHER PLANS AND DOCUMENTS IN THE DEVELOPMENT CONSENT ORDER

2. ALL DIMENSIONS ARE IN METRES UNLESS STATED OTHERWISE.

SEE PLAN FOR KEY

P01	16/06/21	SGAR3 ISSUE	CDye	AWoo	SCM
C01	16/06/21	SGAR3 ISSUE	CDye	AWoo	SCM
P02	01/07/21	DCO ISSUE	CDye	AWoo	SCM
C02	01/07/21	DCO ISSUE	CDye	AWoo	SCM
P03	15/02/22	UPDATED KEY WITH NEW BRIDLEWAY 'BR'	RO	PE	MMur
P04	10/06/22	DEADLINE SUBMISSION 8	FWg	MMcD	SCM
REV	DATE	REVISION NOTE	ORG	CHKD	APPD

DESIGNER

SWECO

CONTRACTOR

GallifordTry

CLIENT

highways england

PROJECT TITLE
A47 WANSFORD TO SUTTON DUALLING

PROJECT STAGE
PCF STAGE 4

DRAWING TITLE
RIGHTS OF WAY AND ACCESS PLANS REGULATION 5(2)(k) and 5(2)(o) SHEET 2 OF 7

SUITABILITY
SUITABLE FOR INFORMATION

SHEET SIZE A1	SCALE 1:1250	STATUS S2	REVISION P04
-------------------------	------------------------	---------------------	------------------------

DRAWING NUMBER
HE551494-GTY-HKF-000-DR-CH-31002

This drawing should not be relied on or used in circumstances other than those for which it was originally prepared and for which Sweco UK Ltd was commissioned. Sweco UK Ltd accepts no responsibility for this drawing to any party other than the person by whom it was commissioned. This drawing has been prepared on behalf of Galliford Try by Sweco UK Ltd for the titled project or named part thereof and should not be relied upon or used for any other project without an independent check being carried out as to its suitability and prior written authority of Galliford Try being obtained. Sweco UK Ltd accepts no responsibility or liability for the consequences of this drawing being used for a purpose other than for which it was commissioned. Any person using or relying on this drawing for such other purpose agrees, and will by such use or reliance be taken to confirm his/her agreement, to indemnify Sweco UK Ltd for all loss or damage resulting therefrom.

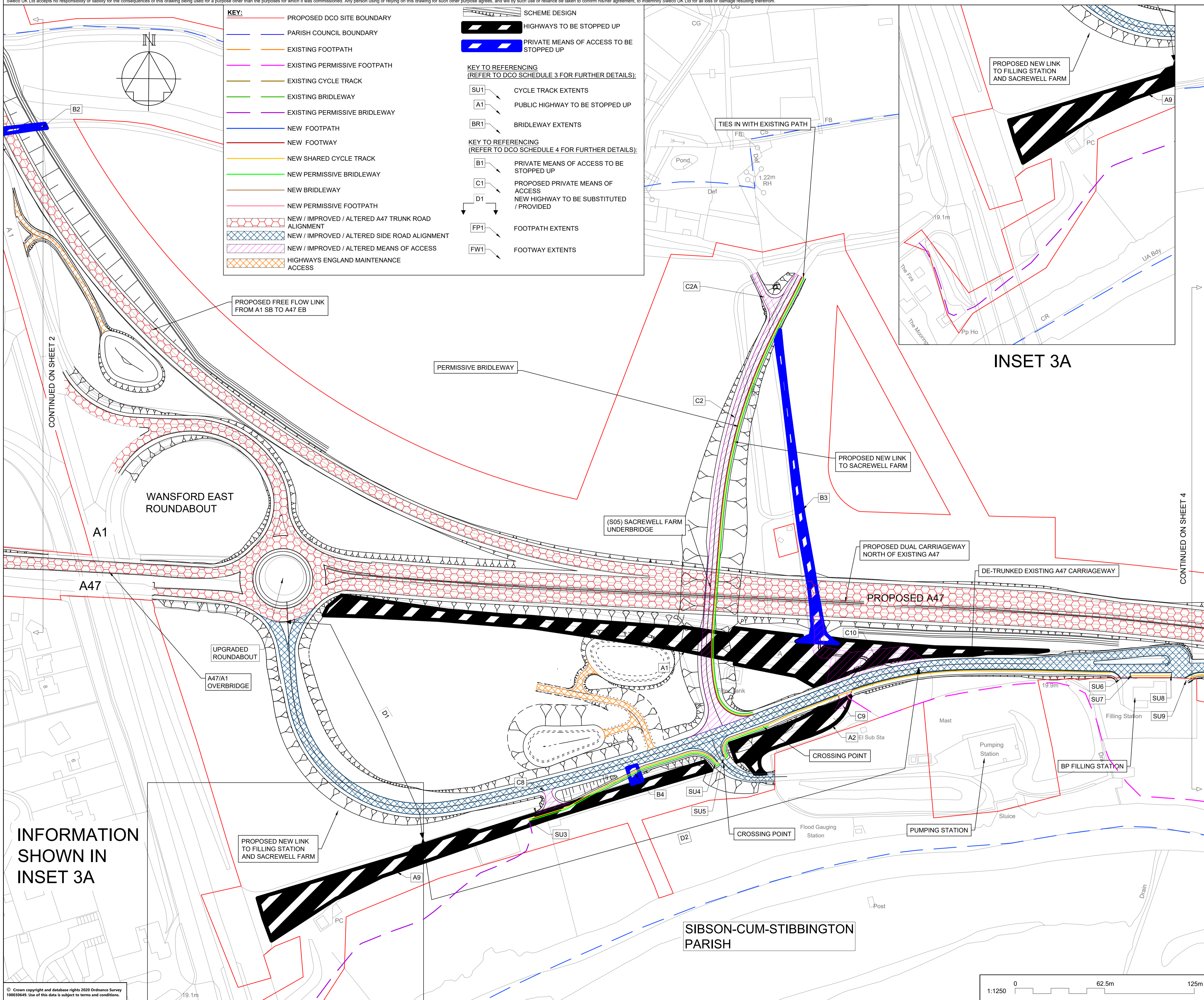

- KEY:**
- PROPOSED DCO SITE BOUNDARY
 - PARISH COUNCIL BOUNDARY
 - EXISTING FOOTPATH
 - EXISTING PERMISSIVE FOOTPATH
 - EXISTING CYCLE TRACK
 - EXISTING BRIDLEWAY
 - EXISTING PERMISSIVE BRIDLEWAY
 - NEW FOOTPATH
 - NEW FOOTWAY
 - NEW SHARED CYCLE TRACK
 - NEW PERMISSIVE BRIDLEWAY
 - NEW BRIDLEWAY
 - NEW PERMISSIVE FOOTPATH
 - NEW // IMPROVED / ALTERED A47 TRUNK ROAD ALIGNMENT
 - NEW // IMPROVED / ALTERED SIDE ROAD ALIGNMENT
 - NEW // IMPROVED / ALTERED MEANS OF ACCESS
 - HIGHWAYS ENGLAND MAINTENANCE ACCESS
- SCHEME DESIGN**
- ▨ HIGHWAYS TO BE STOPPED UP
 - ▨ PRIVATE MEANS OF ACCESS TO BE STOPPED UP
- KEY TO REFERENCING (REFER TO DCO SCHEDULE 3 FOR FURTHER DETAILS):**
- SU1 CYCLE TRACK EXTENTS
 - A1 PUBLIC HIGHWAY TO BE STOPPED UP
 - BR1 BRIDLEWAY EXTENTS
- KEY TO REFERENCING (REFER TO DCO SCHEDULE 4 FOR FURTHER DETAILS):**
- B1 PRIVATE MEANS OF ACCESS TO BE STOPPED UP
 - C1 PROPOSED PRIVATE MEANS OF ACCESS
 - D1 NEW HIGHWAY TO BE SUBSTITUTED / PROVIDED
 - FP1 FOOTPATH EXTENTS
 - FW1 FOOTWAY EXTENTS

NOTES

Purpose of use
FOR DCO SUBMISSION

Development Consent Order Number / Document
TR010039/APP/2.4

SHEET PLAN

SHEETS 1 - 7 (INCLUDES INSETS 3A, 5B AND 7C)

WANSFORD RAILWAY UNDERPASS

5B

2 3 4 5 6 7

A47/A1 JUNCTION SACREWELL FARM UNDERBRIDGE NEW ROUNDABOUT

1. THESE PLANS SHOULD BE READ IN CONJUNCTION WITH OTHER PLANS AND DOCUMENTS IN THE DEVELOPMENT CONSENT ORDER
2. ALL DIMENSIONS ARE IN METRES UNLESS STATED OTHERWISE.

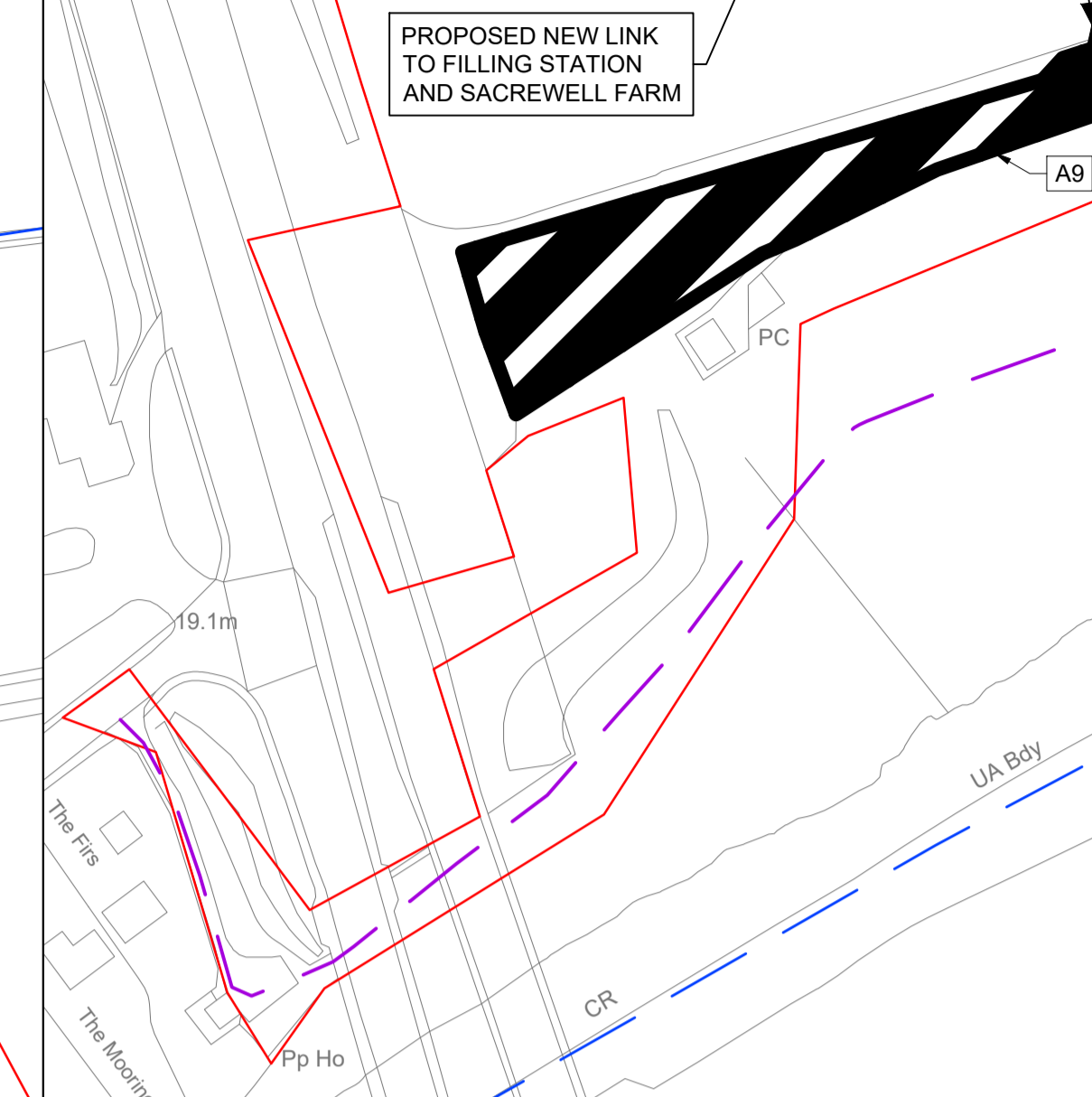

REV	DATE	REVISION NOTE	ORG	CHKD	APPD
P01	16/06/21	SGAR3 ISSUE	CDye	AWoo	SCM
CD1	16/06/21	SGAR3 ISSUE	CDye	AWoo	SCM
P02	01/07/21	DCO ISSUE	CDye	AWoo	SCM
C02	01/07/21	DCO ISSUE	CDye	AWoo	SCM
P03	15/02/22	UPDATED KEY WITH NEW BRIDLEWAY 'BR'	RO	PE	MMur
P04	10/06/22	DEADLINE SUBMISSION 8	FWig	MMcD	SCM

DESIGNER
SWECO

CONTRACTOR
GallifordTry

CLIENT
highways england

PROJECT TITLE
A47 WANSFORD TO SUTTON DUALLING

PROJECT STAGE
PCF STAGE 4

DRAWING TITLE
**RIGHTS OF WAY AND ACCESS PLANS
REGULATION 5(2)(k) and 5(2)(o)
SHEET 3 OF 7**

SUITABILITY
SUITABLE FOR INFORMATION

SHEET SIZE	SCALE	STATUS	REVISION
A1	1:1250	S2	P04

DRAWING NUMBER
HE551494-GTY-HKF-000-DR-CH-31003

INFORMATION SHOWN IN INSET 3A

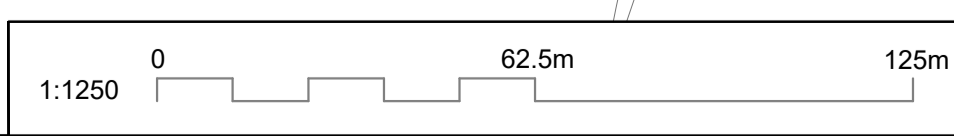

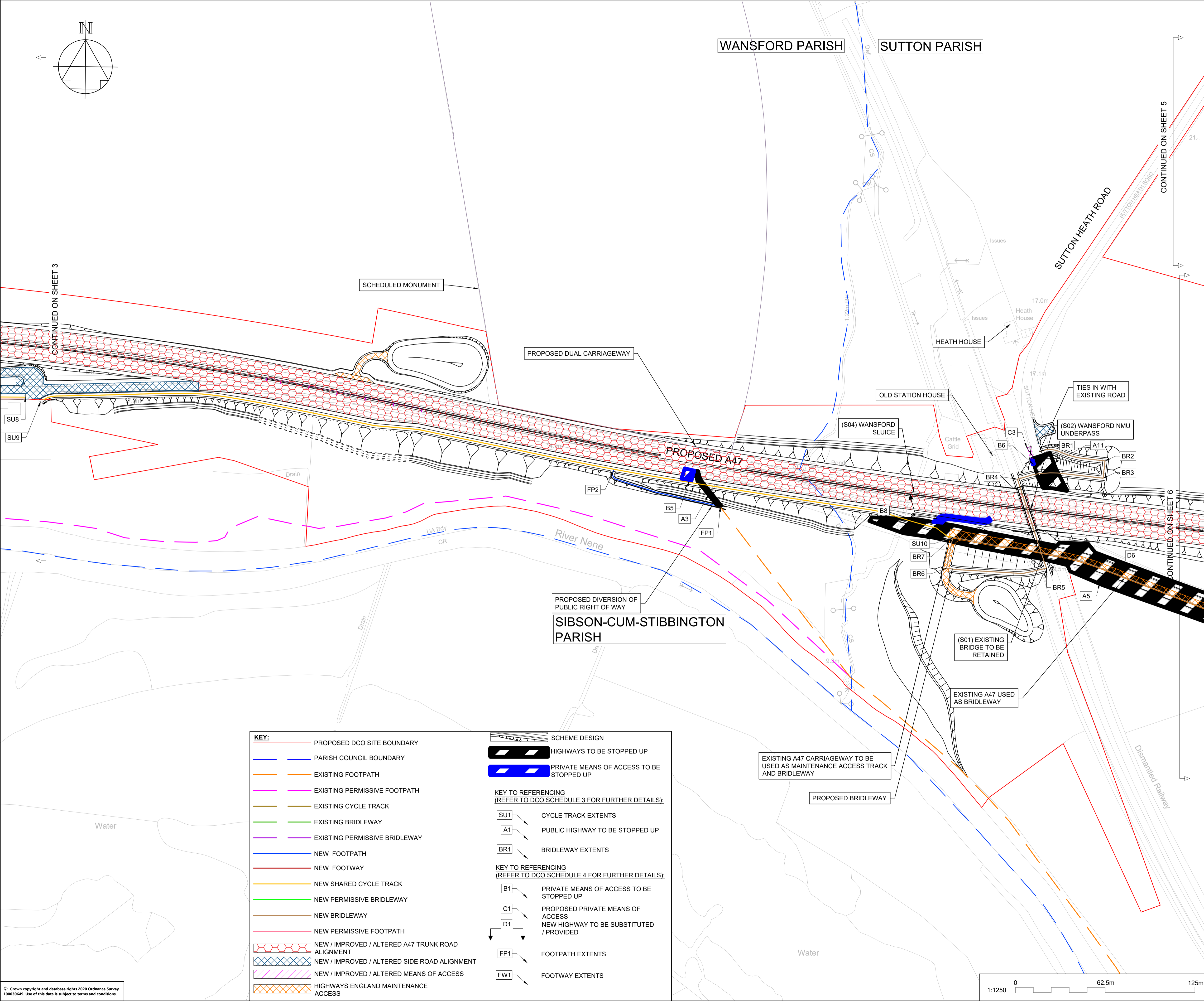

NOTES

Purpose of use
FOR DCO SUBMISSION

Development Consent Order Number / Document
TR010039/APP/2.4

SHEET PLAN

SHEETS 1 - 7 (INCLUDES INSETS 3A, 5B AND 7C).

WANSFORD RAILWAY UNDERPASS
5B

A47/A1 JUNCTION
3A

SACREWELL FARM UNDERBRIDGE
7C

NEW ROUNDABOUT
6

- THESE PLANS SHOULD BE READ IN CONJUNCTION WITH OTHER PLANS AND DOCUMENTS IN THE DEVELOPMENT CONSENT ORDER.
- ALL DIMENSIONS ARE IN METRES UNLESS STATED OTHERWISE.

REV	DATE	REVISION NOTE	ORG	CHKD	APPD
P01	16/06/21	SGAR3 ISSUE	CDye	AWoo	SCM
C01	16/06/21	SGAR3 ISSUE	CDye	AWoo	SCM
P02	01/07/21	DCO ISSUE	CDye	AWoo	SCM
C02	01/07/21	DCO ISSUE	CDye	AWoo	SCM
P03	15/02/22	UPDATED KEY WITH NEW BRIDLEWAY 'BR'	RO	PE	MMur
P04	10/06/22	DEADLINE SUBMISSION 8	FWig	MMcD	SCM

DESIGNER
SWECO

CONTRACTOR
GallifordTry

CLIENT
highways england

PROJECT TITLE
A47 WANSFORD TO SUTTON DUALLING

PROJECT STAGE
PCF STAGE 4

DRAWING TITLE
**RIGHTS OF WAY AND ACCESS PLANS
REGULATION 5(2)(k) and 5(2)(o)
SHEET 4 OF 7**

SUITABILITY
SUITABLE FOR INFORMATION

SHEET SIZE	SCALE	STATUS	REVISION
A1	1:1250	S2	P04

DRAWING NUMBER
HE551494-GTY-HKF-000-DR-CH-31004

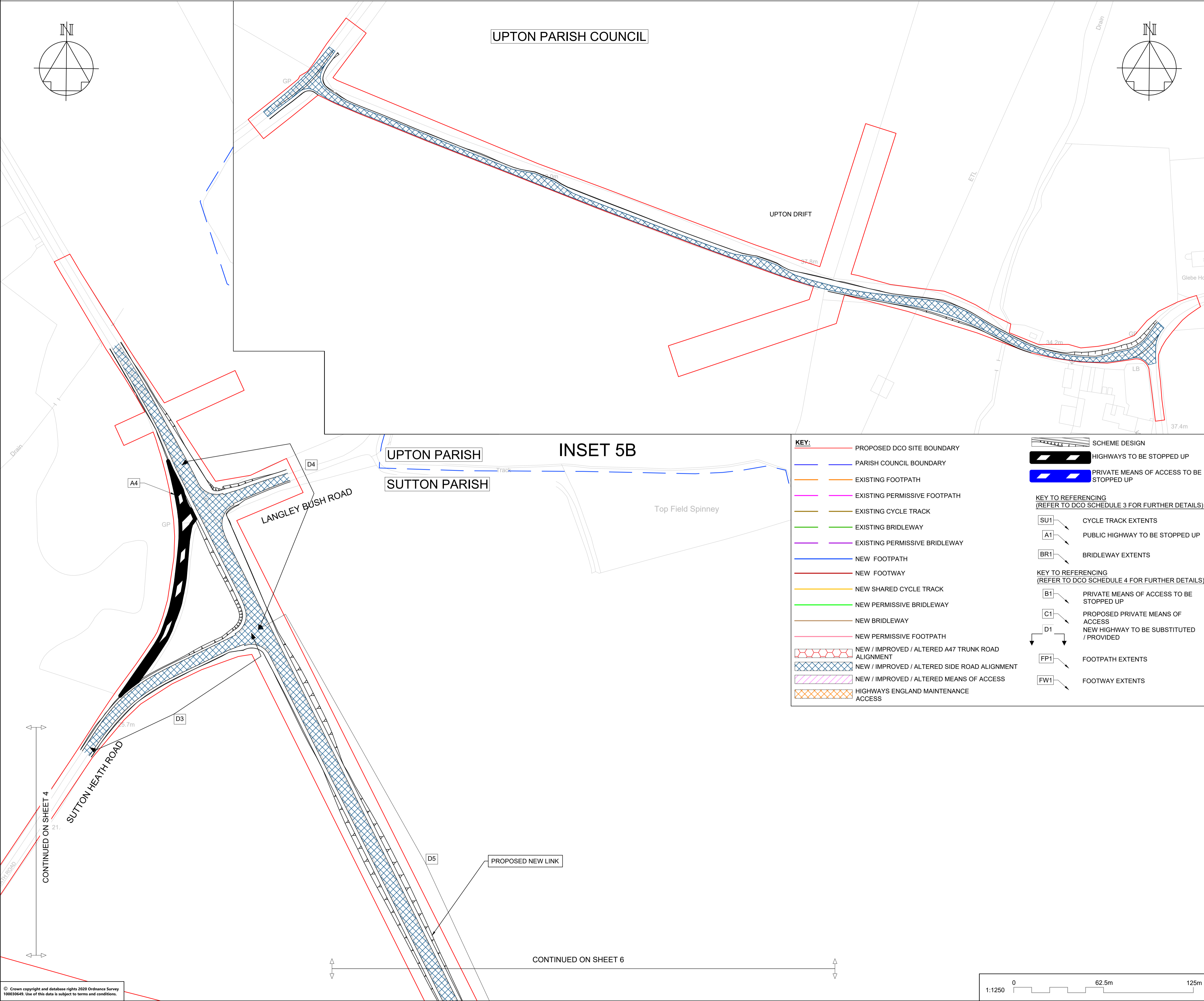

NOTES

Purpose of use
FOR DCO SUBMISSION

Development Consent Order Number / Document
TR010039/APP/2.4

SHEET PLAN

SHEETS 1 - 7 (INCLUDES INSETS 3A, 5B AND 7C)

WANSFORD RAILWAY UNDERPASS 5B

A47/A1 JUNCTION

SACREWELL FARM UNDERBRIDGE

NEW ROUNDABOUT

1. THESE PLANS SHOULD BE READ IN CONJUNCTION WITH OTHER PLANS AND DOCUMENTS IN THE DEVELOPMENT CONSENT ORDER.
2. ALL DIMENSIONS ARE IN METRES UNLESS STATED OTHERWISE.

REV	DATE	REVISION NOTE	ORG	CHKD	APPD
P01	16/06/21	SGAR3 ISSUE	CDye	AWoo	SCM
C01	16/06/21	SGAR3 ISSUE	CDye	AWoo	SCM
P02	01/07/21	DCO ISSUE	CDye	AWoo	SCM
C02	01/07/21	DCO ISSUE	CDye	AWoo	SCM
P03	15/02/22	UPDATED KEY WITH NEW BRIDLEWAY 'BR'	RO	PE	MMur
P04	10/06/22	DEADLINE SUBMISSION 8	FWg	MMcD	SCM

DESIGNER

SWECO

CONTRACTOR

GallifordTry

CLIENT

**highways
england**

PROJECT TITLE

A47 WANSFORD TO SUTTON DUALLING

PROJECT STAGE

PCF STAGE 4

DRAWING TITLE

**RIGHTS OF WAY AND ACCESS PLANS
REGULATION 5(2)(k) and 5(2)(o)
SHEET 5 OF 7**

SUITABILITY

SUITABLE FOR INFORMATION

SHEET SIZE	SCALE	STATUS	REVISION
A1	1:1250	S2	P04

DRAWING NUMBER

HE551494-GTY-HKF-000-DR-CH-31005

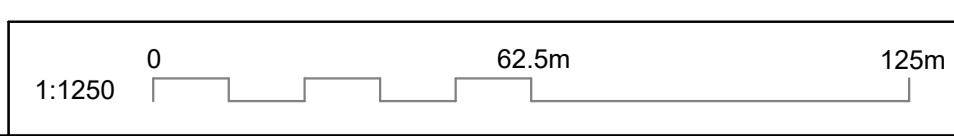

This drawing should not be relied on or used in circumstances other than those for which it was originally prepared and for which Sweco UK Ltd was commissioned. Sweco UK Ltd accepts no responsibility for this drawing to any party other than the person by whom it was commissioned. This drawing has been prepared on behalf of Galliford Try by Sweco UK Ltd for the titled project or named part thereof and should not be relied upon or used for any other project without an independent check being carried out as to its suitability and prior written authority of Galliford Try being obtained. Sweco UK Ltd accepts no responsibility or liability for the consequences of this drawing being used for a purpose other than the purposes for which it was commissioned. Any person using or relying on this drawing for such other purpose agrees, and will by such use or reliance be taken to confirm his/her agreement, to indemnify Sweco UK Ltd for all loss or damage resulting therefrom.

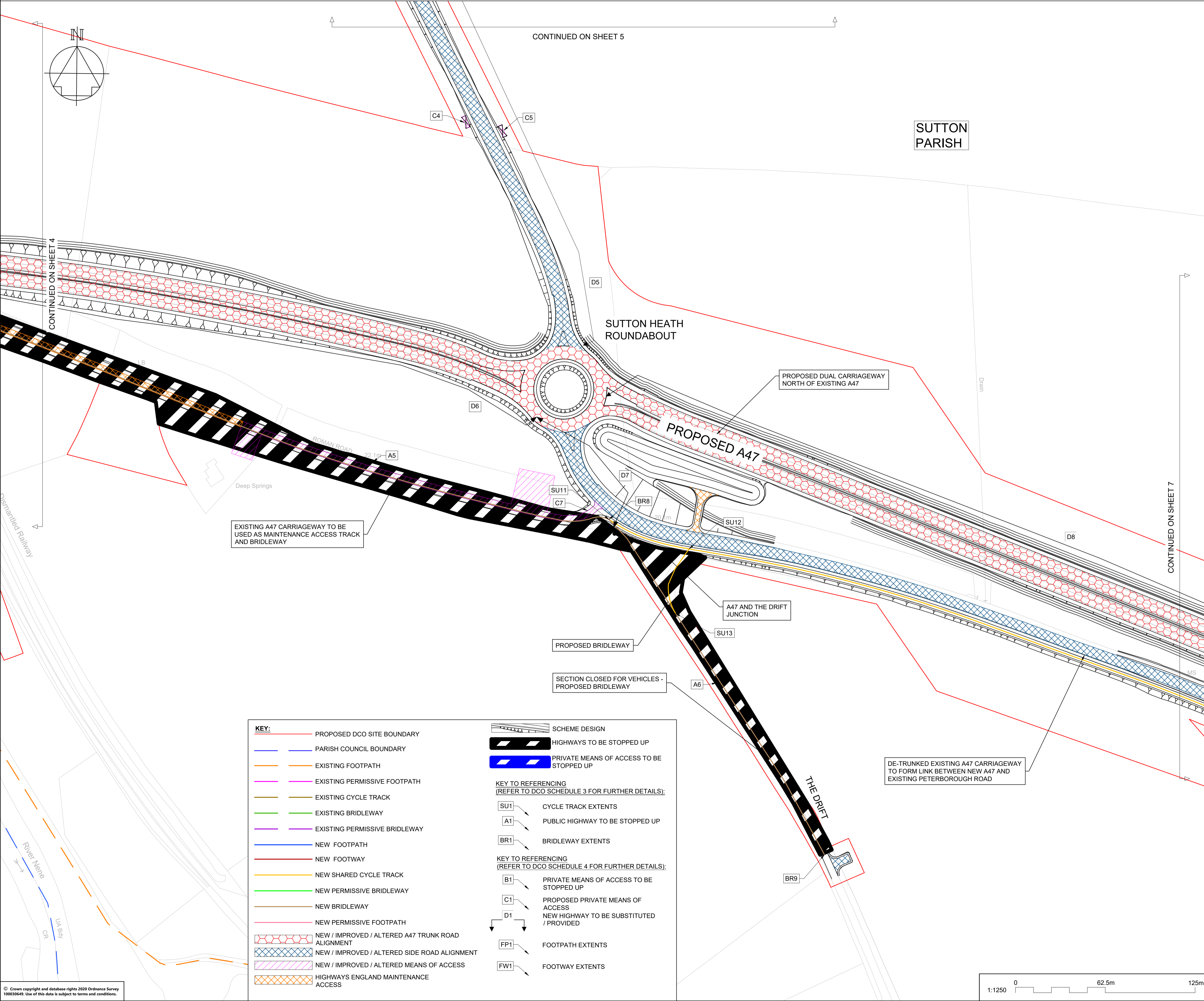

KEY:

- PROPOSED DCO SITE BOUNDARY
- PARISH COUNCIL BOUNDARY
- EXISTING FOOTPATH
- EXISTING PERMISSIVE FOOTPATH
- EXISTING CYCLE TRACK
- EXISTING BRIDLEWAY
- EXISTING PERMISSIVE BRIDLEWAY
- NEW FOOTPATH
- NEW FOOTWAY
- NEW SHARED CYCLE TRACK
- NEW PERMISSIVE BRIDLEWAY
- NEW BRIDLEWAY
- NEW PERMISSIVE FOOTPATH
- NEW / IMPROVED / ALTERED A47 TRUNK ROAD ALIGNMENT
- NEW / IMPROVED / ALTERED SIDE ROAD ALIGNMENT
- NEW / IMPROVED / ALTERED MEANS OF ACCESS
- HIGHWAYS ENGLAND MAINTENANCE ACCESS

SCHEME DESIGN

- HIGHWAYS TO BE STOPPED UP
- PRIVATE MEANS OF ACCESS TO BE STOPPED UP

KEY TO REFERENCING (REFER TO DCO SCHEDULE 3 FOR FURTHER DETAILS):

- SU1 - CYCLE TRACK EXTENTS
- A1 - PUBLIC HIGHWAY TO BE STOPPED UP
- BR1 - BRIDLEWAY EXTENTS

KEY TO REFERENCING (REFER TO DCO SCHEDULE 4 FOR FURTHER DETAILS):

- B1 - PRIVATE MEANS OF ACCESS TO BE STOPPED UP
- C1 - PROPOSED PRIVATE MEANS OF ACCESS
- D1 - NEW HIGHWAY TO BE SUBSTITUTED / PROVIDED
- FP1 - FOOTPATH EXTENTS
- FW1 - FOOTWAY EXTENTS

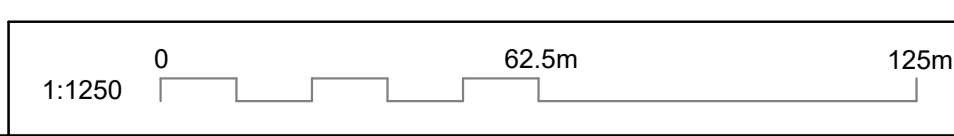

© Crown copyright and database rights 2020 Ordnance Survey 100030640. Use of this data is subject to terms and conditions.

NOTES

Purpose of use
FOR DCO SUBMISSION

Development Consent Order Number / Document
TR010039/APP/2.4

SHEET PLAN

SHEETS 1 - 7 (INCLUDES INSETS 3A, 5B AND 7C)

WANSFORD RAILWAY UNDERPASS 5B
A47/A1 JUNCTION 3A
SACREWELL FARM UNDERBRIDGE 7C
NEW ROUNDABOUT 6

- THESE PLANS SHOULD BE READ IN CONJUNCTION WITH OTHER PLANS AND DOCUMENTS IN THE DEVELOPMENT CONSENT ORDER
- ALL DIMENSIONS ARE IN METRES UNLESS STATED OTHERWISE.

REV	DATE	REVISION NOTE	ORG	CHKD	APPD
P01	16/06/21	SGAR3 ISSUE	CDye	AWoo	SCM
C01	16/06/21	SGAR3 ISSUE	CDye	AWoo	SCM
P02	01/07/21	DCO ISSUE	CDye	AWoo	SCM
C02	01/07/21	DCO ISSUE	CDye	AWoo	SCM
P03	15/02/22	UPDATED KEY WITH NEW BRIDLEWAY 'BR'	RO	FE	MMur
P04	10/06/22	DEADLINE SUBMISSION 8	FWig	MMcD	SCM

DESIGNER

CONTRACTOR

CLIENT

PROJECT TITLE
A47 WANSFORD TO SUTTON DUALLING

PROJECT STAGE
PCF STAGE 4

DRAWING TITLE
**RIGHTS OF WAY AND ACCESS PLANS
REGULATIONS 5(2)(k) and 5(2)(o)
SHEET 6 OF 7**

SUITABILITY
SUITABLE FOR INFORMATION

SHEET SIZE	SCALE	STATUS	REVISION
A1	1:1250	S2	P04

DRAWING NUMBER
HE551494-GTY-HKF-000-DR-CH-31006

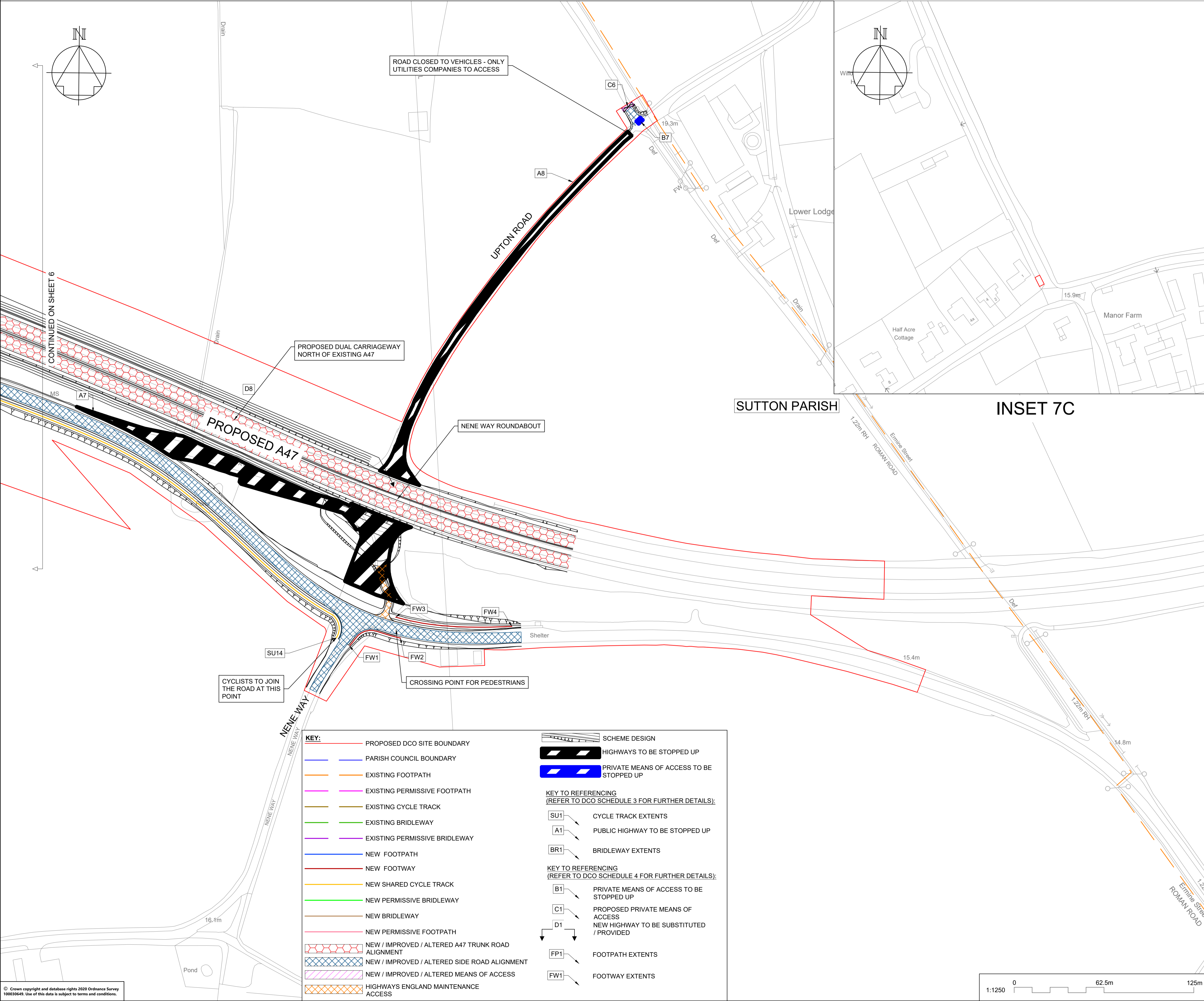

NOTES

Purpose of use
FOR DCO SUBMISSION

Development Consent Order Number / Document
TR010039/APP/2.4

SHEET PLAN

SHEETS 1 - 7 (INCLUDES INSETS 3A, 5B AND 7C)

WANSFORD RAILWAY UNDERPASS 5B

A47/A1 JUNCTION 3A

SACREWELL FARM UNDERBRIDGE 7C

NEW ROUNDABOUT 7

- THESE PLANS SHOULD BE READ IN CONJUNCTION WITH OTHER PLANS AND DOCUMENTS IN THE DEVELOPMENT CONSENT ORDER.
- ALL DIMENSIONS ARE IN METRES UNLESS STATED OTHERWISE.

REV	DATE	REVISION NOTE	ORG	CHKD	APPD
P01	16/06/21	SGAR3 ISSUE	CDye	AWoo	SCM
C01	16/06/21	SGAR3 ISSUE	CDye	AWoo	SCM
P02	01/07/21	DCO ISSUE	CDye	AWoo	SCM
C02	01/07/21	DCO ISSUE	CDye	AWoo	SCM
P03	15/02/22	UPDATED KEY WITH NEW BRIDLEWAY 'BR'	RO	PE	MMur
P04	10/06/22	DEADLINE SUBMISSION 8	FWig	MMcD	SCM

DESIGNER

SWECO

CONTRACTOR

GallifordTry

CLIENT

highways england

PROJECT TITLE

A47 WANSFORD TO SUTTON DUALLING

PROJECT STAGE

PCF STAGE 4

DRAWING TITLE

**RIGHTS OF WAY AND ACCESS PLANS
REGULATIONS 5(2)(k) and 5(2)(o)
SHEET 7 OF 7**

SUITABILITY

SUITABLE FOR INFORMATION

SHEET SIZE A1	SCALE 1:1250	STATUS S2	REVISION P04
-------------------------	------------------------	---------------------	------------------------

DRAWING NUMBER
HE551494-GTY-HKF-000-DR-CH-31007

NOTES

Purpose of use
FOR DCO SUBMISSION

Development Consent Order Number / Document
TR010039/APP/2.4

1. THESE PLANS SHOULD BE READ IN CONJUNCTION WITH OTHER PLANS AND DOCUMENTS IN THE DEVELOPMENT CONSENT ORDER.
 2. ALL DIMENSIONS ARE IN METRES UNLESS STATED OTHERWISE.

KEY TO SYMBOLS

 ORDER LIMITS
 SCHEME DESIGN

REV	DATE	REVISION NOTE	ORG	CHK'D	APP'D
P01	16/06/21	SGAR3 ISSUE	CDye	AWoo	SCM
C01	16/06/21	SGAR3 ISSUE	CDye	AWoo	SCM
P02	01/07/21	DCO ISSUE	CDye	AWoo	SCM
C02	01/07/21	DCO ISSUE	CDye	AWoo	SCM

DESIGNER



CONTRACTOR



CLIENT



PROJECT TITLE

A47 WANSFORD TO SUTTON DUALLING

PROJECT STAGE

PCF STAGE 4

DRAWING TITLE

**PUBLIC RIGHTS OF WAY AND ACCESS PLANS
 REGULATIONS 5(2)(k) and 5(2)(o)
 KEY PLAN**

SUITABILITY

AUTHORISED AS STAGE 3 COMPLETED

SHEET SIZE	SCALE	STATUS	REVISION
A1	1:10000	A3	C02

DRAWING NUMBER

HE551494-GTY-HKF-000-DR-CH-31008

